

How to Transform Learning Centers into STEM Hubs of Learning

McHenry School District 15



McHenry School District 15



Today's Learners...Tomorrow's Leaders



Before bringing this transformative project to the Board of Education, the district engaged staff in meaningful discussions regarding Science, Technology Engineering, and Mathematics (STEM) curriculum and what that would look like in a K-8 district.

This led to curriculum organization and age-appropriate material selection for students in primary and middle schools.

Upon these decisions, the district met with principals, staff, and architects to create a new 21st century learning space in each of its schools that were accustomed to outdated traditional learning centers. Through collaboration with these stakeholders, each of the learning centers was innovatively redesigned with a focus on innovation and best practices, while also being conscious of budget restraints. To finance the projects, the district developed a funding plan that would allow all of the learning centers to be constructed over a one-year period. The next step was presenting the curriculum and construction projects to the sub-committees of the board.

This project was successful because the district engaged key stakeholders early in the process and leveraged their ideas and input to make decisions that would garner staff and board support. The end results are STEM-ready learning centers that are now successfully providing students with cutting-edge 21st century learning opportunities.

Parkland School



PARKLAND SCHOOL

9,960 SF

Includes: STEM Lab, Innovation Center, Library, Broadcast Studio, Control Room, Classroom











McHenry Middle School

McHENRY MIDDLE SCHOOL

9,100 SF

Includes: STEM Lab, Innovation Center,
Library, Broadcast Studio, Control Room,
Classroom

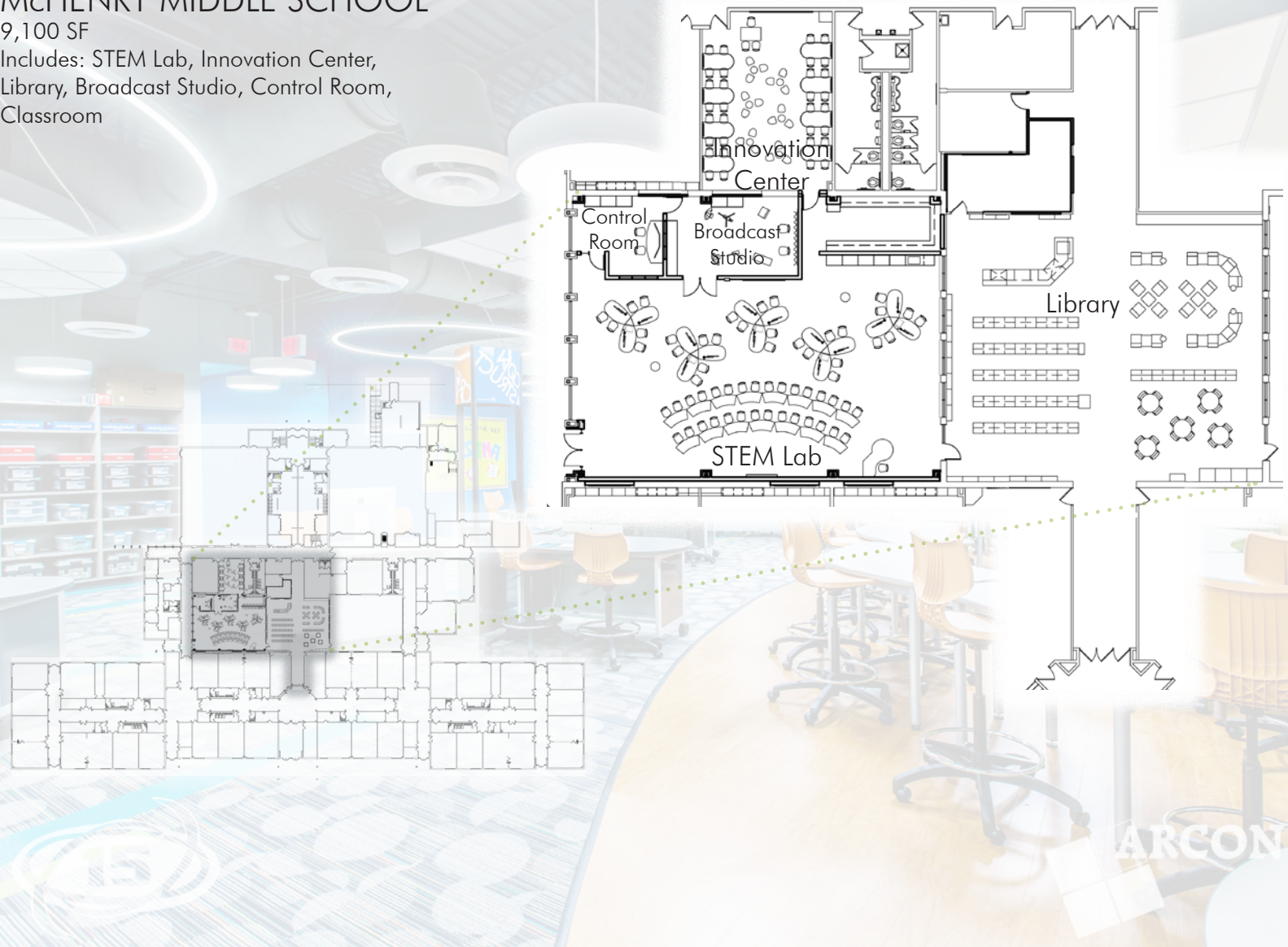

ARCON





Control Room





Riverwood Elementary

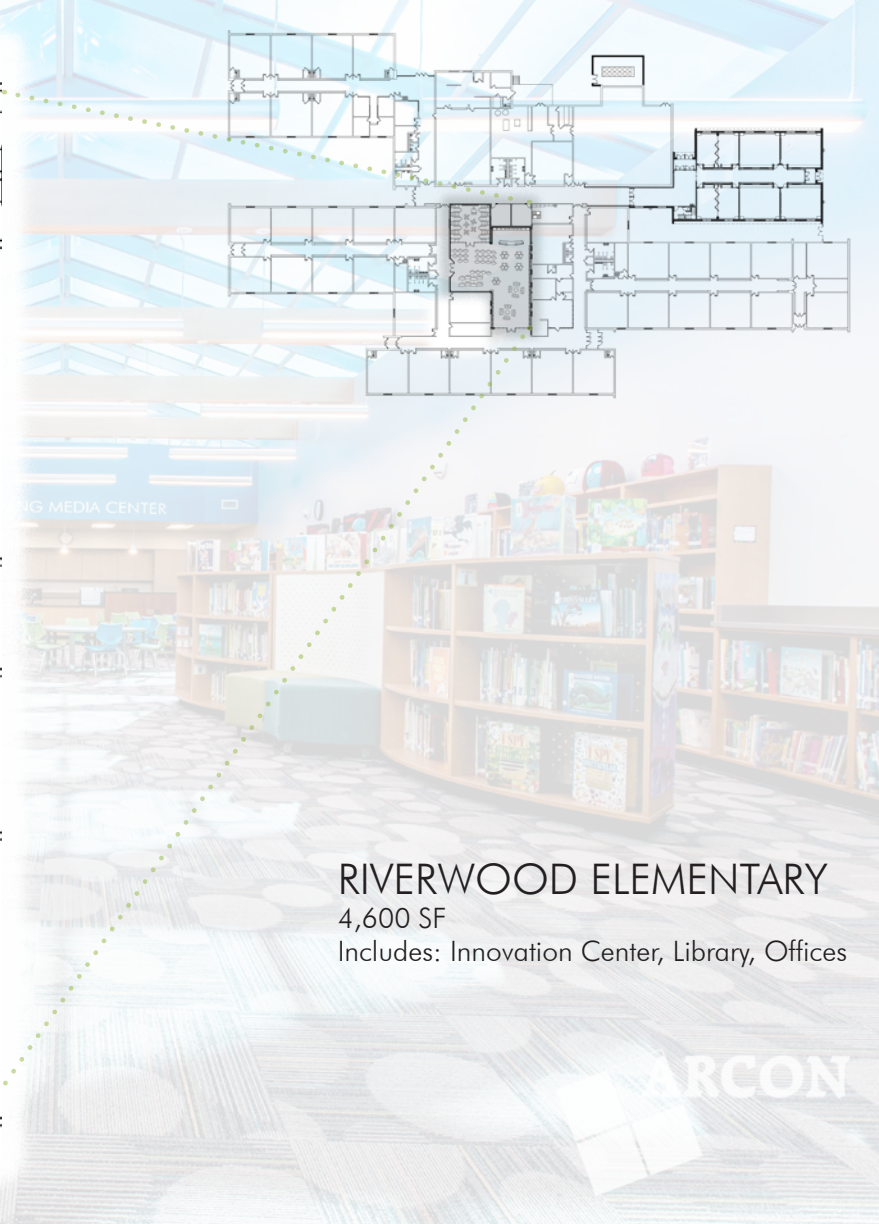
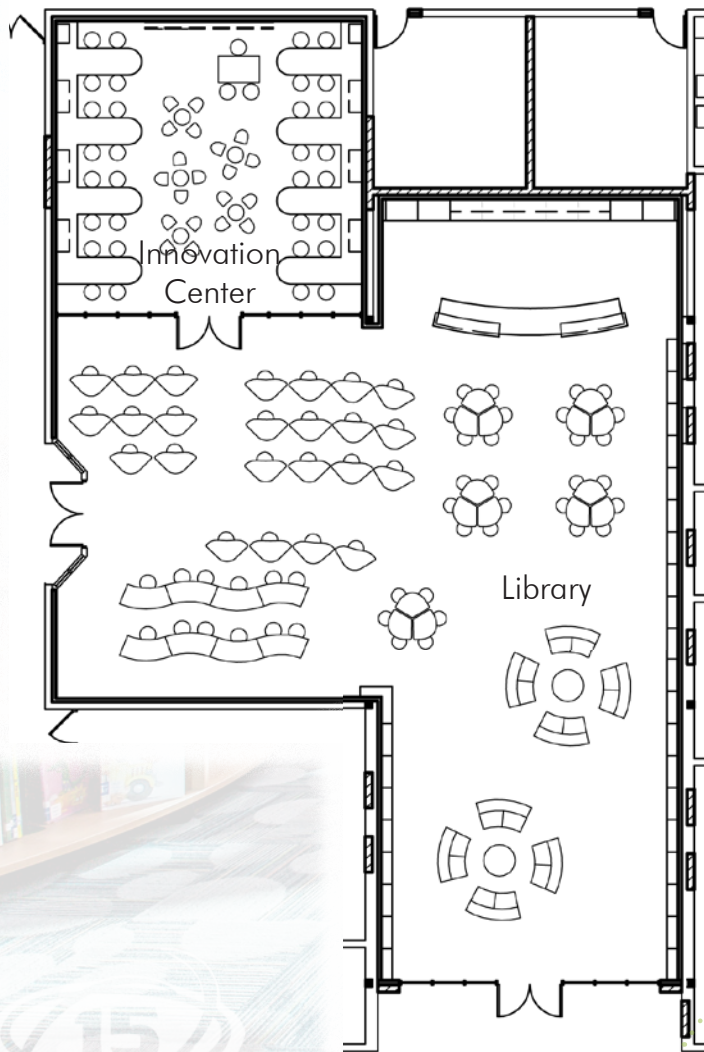

RIVERWOOD ELEMENTARY

4,600 SF

Includes: Innovation Center, Library, Offices

ARCON





LEARNING MEDIA CENTER





EXPLORE **AIM HIGH** **TEAMWORK** **CHALLENGE**
DEDICATION RESPECT COMMITMENT ACHIEVE
LEARN **CREATE** BELIEVE
INSPIRE DREAM FOCUS

ARCON



INNOVATION CENTER

Welcome to the
Innovation Center

LEARNING MEDIA CENTER





McHenry School District 15

superintendent

Dr. R. Alan Hoffman
ahoffman@d15.org

assistant superintendent

Dr. Josh Reitz
jreitz@d15.org



executive director of learning/technology

Dr. Fred Laudadio
flaudadio@d15.org

Today's Learners...Tomorrow's Leaders

mchenry school district 15
1011 north green street
mchenry, illinois 60050

principal-in-charge

William M. Strejc, AIA
wmstrejc@arconassoc.com



project manager | associate principal

Gaspere P. Pitrello, ALA, NCARB
gppitrello@arconassoc.com

2050 south finley road, suite 40
lombard, illinois 60148

architecture | construction management | roof and masonry consulting
environmental consulting | landscape architecture | interior design
630.495.1900 | www.arconassoc.com